

PROJECT NAME: _____

LOCATION: _____

SPECIFIER ITEM NO. _____ **QTY:** _____

ENCORE PART NO. _____

Encore[®] Wall Mount Faucet with
Tubular Swing Spout and Lever Handles

KL54-8xxx-SE1 Series

- KL54-8106-SE1 6" Spout, Ceramic Valves
- KL54-8006-SE1 6" Spout, Compression Valves
- KL54-8108-SE1 8" Spout, Ceramic Valves
- KL54-8008-SE1 8" Spout, Compression Valves
- KL54-8110-SE1 10" Spout, Ceramic Valves
- KL54-8010-SE1 10" Spout, Compression Valves
- KL54-8112-SE1 12" Spout, Ceramic Valves
- KL54-8012-SE1 12" Spout, Compression Valves
- KL54-8114-SE1 14" Spout, Ceramic Valves
- KL54-8014-SE1 14" Spout, Compression Valves
- KL54-8116-SE1 16" Spout, Ceramic Valves
- KL54-8016-SE1 16" Spout, Compression Valves

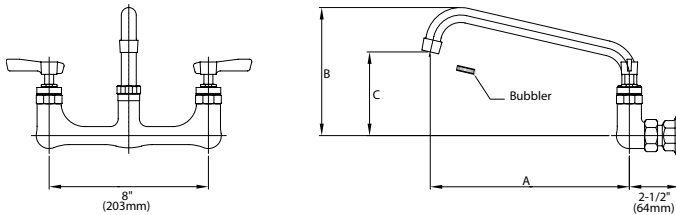

Dimensions shown in inches (mm) are for reference only and are subject to change.

1-1/2" (29mm) hole for backsplash is recommended to accommodate 1/2" supply nipples.

1/2" NPT Female Inlets

Operating Temperature: 40 - 180°F (5 - 83°C)

Operating Pressure: 15 - 125psi

Approximate shipping weight - 5 lbs
Warranty - 2 years parts

Solid heavy duty cast body is specification and commercial quality

Commercial Quality Features

- Tubular swing spout design
- ADA-compliant lever handles
- Built-in check valve to prevent cross-flow and back-flow
- Leak proof double O-ring spout design
- Stainless steel spout

SANIGUARD[®] Product Protection

- Permanently incorporated on all touch points of Encore plumbing fixtures
- Inorganic, silver ion technology inhibits growth of common bacteria, yeasts, mold and fungi, minimizes cross-contamination

SPECIFICATIONS:

Wall Mount Faucet to be Encore KL54 Series in the following configuration:

- _____ KL54-8106-SE1 6" Spout, Ceramic Valves
- _____ KL54-8006-SE1 6" Spout, Compression Valves
- _____ KL54-8108-SE1 8" Spout, Ceramic Valves
- _____ KL54-8008-SE1 8" Spout, Compression Valves
- _____ KL54-8110-SE1 10" Spout, Ceramic Valves
- _____ KL54-8010-SE1 10" Spout, Compression Valves
- _____ KL54-8112-SE1 12" Spout, Ceramic Valves
- _____ KL54-8012-SE1 12" Spout, Compression Valves
- _____ KL54-8114-SE1 14" Spout, Ceramic Valves
- _____ KL54-8014-SE1 14" Spout, Compression Valves
- _____ KL54-8116-SE1 16" Spout, Ceramic Valves
- _____ KL54-8016-SE1 16" Spout, Compression Valves

Faucet body to be constructed of polished chrome plated brass with total lead content less than 0.25% by weighted average. Lever handles to be incorporated with SANIGUARD treatment. Valves to be 1/4-turn with integral check valve to prevent cross-flow and back-flow. Spout to be stainless steel tubular swing style with leak proof double O-ring seal design. Color coded temperature indexes shall meet international standards. 2.2gpm aerator @ 60psi standard with full flow stream bubbler screen spout tip.

Model No.	A	B	C
KL54-8106-SE1	6" (152mm)	5-9/16" (141mm)	3-5/16" (84mm)
KL54-8006-SE1	6" (152mm)	5-9/16" (141mm)	3-5/16" (84mm)
KL54-8108-SE1	8" (203mm)	6-1/16" (154mm)	3-13/16" (96mm)
KL54-8008-SE1	8" (203mm)	6-1/16" (154mm)	3-13/16" (96mm)
KL54-8110-SE1	10" (254mm)	6-1/2" (165mm)	4-1/4" (108mm)
KL54-8010-SE1	10" (254mm)	6-1/2" (165mm)	4-1/4" (108mm)
KL54-8112-SE1	12" (305mm)	6-15/16" (176mm)	4-11/16" (120mm)
KL54-8012-SE1	12" (305mm)	6-15/16" (176mm)	4-11/16" (120mm)
KL54-8114-SE1	14" (355mm)	7-7/16" (187mm)	5-3/16" (131mm)
KL54-8014-SE1	14" (355mm)	7-7/16" (187mm)	5-3/16" (131mm)
KL54-8116-SE1	16" (406mm)	7-7/8" (200mm)	5-5/8" (143mm)
KL54-8016-SE1	16" (406mm)	7-7/8" (200mm)	5-5/8" (143mm)

COMPLIES WITH:
THE FEDERAL "REDUCTION OF LEAD
IN DRINKING WATER ACT" -
2011 - US SENATE BILL NO. S.3874
NSF/ANSI 61/9, ANNEX G



Faucet Configurator for KL54-8000 Series

PREMIUM PLUMBING PRODUCTS
Encore[®]

1890 Swarthmore Avenue, PO Box 2020, Lakewood, NJ 08701
Phone: 800-526-3694, 732-363-4700, Fax: 732-364-8110
www.encoreplumbing.com

K x x x - x x x x - x x x

BODY

KL54 = CP POLISHED BRASS SPLASH MOUNT FAUCET BODY WITH ADJUSTABLE SPOUT OUTLET

INLET

8 = 8" (203mm) CTR- 1/2" NPSM INTEGRAL CAST INLETS
1 = 8" (203mm) WITH 2-1/2" OFFSET SUPPLY INLETS WITH BUILT-IN STOPS

VALVE

0 = 1/4 TURN STANDARD ENCORE[®] COMPRESSION VALVE W/BUILT IN CHECK
1 = 1/4 TURN CERAMIC VALVE W/ INLINE CHECK VALVE
2 = SELF CLOSING ADJUSTABLE METERING VALVE

SPOUT

00 = 3-1/2" (89mm) GOOSENECK
01 = 8-1/2" (216mm) GOOSENECK
02 = 6" (152mm) GOOSENECK
06 = 6" (152mm) TUBULAR OR CAST SWING SPOUT
08 = 8" (203mm) TUBULAR SWING SPOUT
10 = 10" (254mm) TUBULAR SWING SPOUT
12 = 12" (305mm) TUBULAR SWING SPOUT
14 = 14" (356mm) TUBULAR SWING SPOUT
16 = 16" (406mm) TUBULAR SWING SPOUT
18A = 18" (457mm) TUBULAR SWING SPOUT
18 = 18" (457mm) DOUBLE JOINTED SWING SPOUT
24 = 24" (609mm) DOUBLE JOINTED SWING SPOUT

SPOUT STYLE

S = ADJUSTABLE SPOUT
R = RIGID TUBULAR SPOUT
T = CAST TUBULAR SPOUT (6" ONLY)

AERATOR

A = 0.5 GPM PCA SPRAY VANDAL RESISTANT
B = 1.5 GPM MAX LAMINAR VANDAL RESISTANT - SANIGUARD
C = 0.5 GPM PCA SPRAY
D = 1.5 GPM MAX LAMINAR - SANIGUARD
E = 2.2 GPM MAX AERATED STREAM
F = 2.2 GPM MAX AERATED STREAM VANDAL RESISTANT
G = .35 GPM PCA SPRAY (MALE)
H = 2.2 GPM MAX AERATED STREAM VANDAL & HOSE RESISTANT
J = .35 GPM PCA SPRAY
K = .35 GPM PCA SPRAY (MALE) VANDAL RESISTANT
L = .35 GPM PCA SPRAY VANDAL RESISTANT
M = 1.0 GPM PCA LAMINAR FLOW
S = 6.0 GPM MAX WIDE ROSE SPRAY

HANDLE

1 = STANDARD ENCORE[®] LEVER - SANIGUARD
2 = CROSS - SANIGUARD
4 = 4" (102mm) WRIST BLADE - SANIGUARD
5 = STANDARD LEVER W/TAMPER PROOF SCREW - SANIGUARD
6 = 6" (152mm) WRIST BLADE - SANIGUARD
7 = 4" (102mm) WRIST BLADE W/ TAMPER PROOF SCREW - SANIGUARD
8 = 6" (152mm) WRIST BLADE W/TAMPER PROOF SCREW - SANIGUARD